



# CORNERSTONE

KALYAN (W)



TWO TRUSTED LEGACIES,

**ONE  
UNIQUE  
OPPORTUNITY.**

---

GET  
TWO STEPS AHEAD,  
WITH JUST ONE MOVE.

---

225+

LANDMARKS

---

20,000+

HAPPY FAMILIES

---

1 CR+

SQ. FT. AREA  
TRANSFORMED

---

35+

YEARS OF  
EXPERIENCE

# NO ONE KNOWS KALYAN BETTER & THE GROWTH HERE IS INEVITABLE!

---

Kalyan is growing for the whole of last decade and the last two years have been phenomenal. It is emerging as one of the most preferred residential destinations for many. Hence, it is witnessing great infrastructural development taking the property price to new peaks.



IDEAL DESTINATION FOR INVESTMENT



SEAMLESS CONNECTIVITY



WELL DEVELOPED INFRASTRUCTURE



EASY ENTRY PRICE - POINTS



MEDICAL AND EDUCATIONAL INSTITUTES  
IN THE NEIGHBOURHOOD



RECREATIONAL CENTRES NEARBY

# UPCOMING INFRASTRUCTURE

---



## KALYAN METRO LINE

Metro Line 5 - Thane - Bhiwandi - Kalyan  
Metro Line 12 - Kalyan - Taloja.



## 6 LANE THANE - DOMBIVALI LINK ROAD

The six-lane Thane - Dombivali  
Link Road will link Thane - Kalyan  
- Dombivali and is set to decrease  
the travel time.



## 26 KMS. LONG KALYAN - DOMBIVALI RING - ROAD

The 26 kms. Ring Road planned by  
MMRDA will pass through Dombivali,  
Kalyan, Ambivli and Titwala in close  
proximity to Samruddhi Mahamarg.



## AIROLI - KALYAN FREEWAY

The freeway connector links Kalyan -  
Dombivali to the IT hub of Airoli  
thereby increasing commuting  
convenience for IT job seekers.

NAGPUR MUMBAI SAMRUDDHI MAHAMARG

VIRAR ALIBAUG MULTIMODAL CORRIDOR

**ELEVATE TO  
A TIMELESS  
EXPERIENCE**

---



**CORNERSTONE**

1 & 2 BHK PREMIUM HOMES

- GROUND FLOOR FOR RETAIL SPACES
  - 2 FLOORS FOR COMMERCIAL SPACES
  - 13 FLOORS OF RESIDENTIAL APARTMENTS
  - WORLD-CLASS AMENITIES
- 



# KALYAN'S MOST ESTABLISHED NEIGHBOURHOOD



## SCHOOLS & COLLEGES

DON BOSCO	5 mins.
BIRLA COLLEGE	7 mins.
BIRLA SCHOOL	10 mins.
SACRED HEART SCHOOL	10 mins.

## HOSPITALS

YASHODHAN HOSPITAL	7 mins.
SIDDHIVINAYAK SPECIALITY HOSPITAL	7 mins.
SANJEEVANI HOSPITAL	7 mins.

## SHOPPING MALLS

RELIANCE DIGITAL MALL	10 mins.
CROMA ELECTRONIC MALL	12 mins.
VIJAY SALES	15 mins.

## RESTAURANTS

PIZZA HUT	7 mins.
DOMINO'S	7 mins.
Mc DONALD'S	12 mins.

## TRANSIT STATIONS

SHAHAD STATION	5 mins.
KALYAN STATION	10 mins.





PRIVATE DECKS



GREEN SPACES



EV CHARGING STATIONS



GYMNASIUM



KIDS' PLAY AREA



SOLAR PANELS

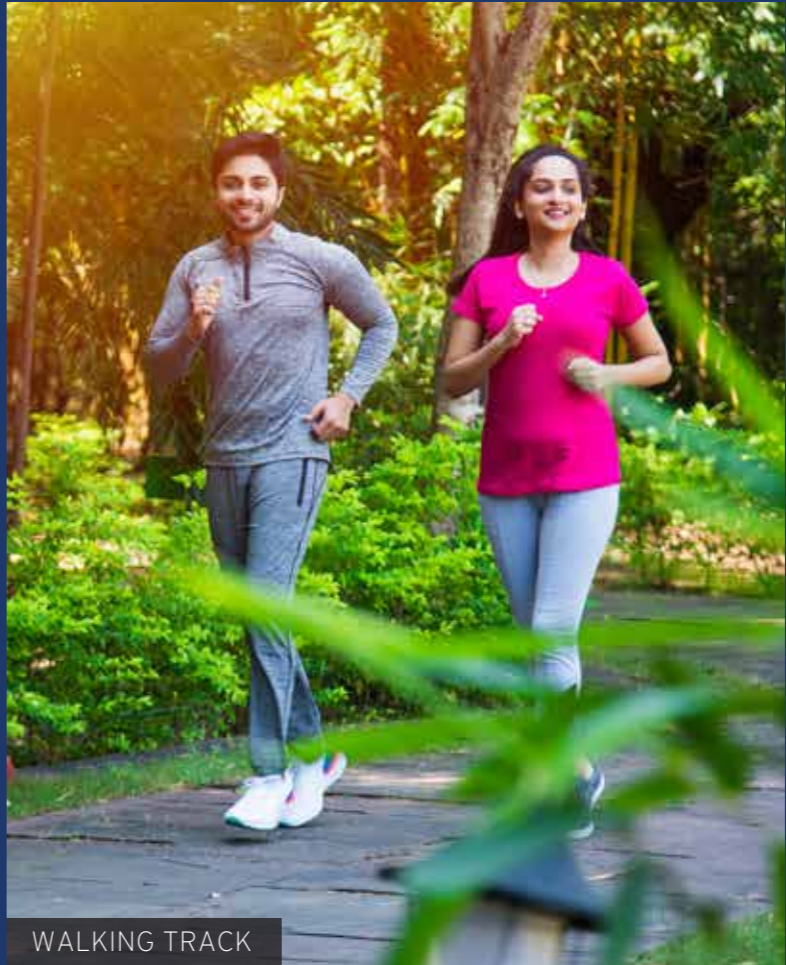

WALKING TRACK

Stock images used for representational purpose only



**ELEVATE TO  
TIMELESS VIEWS**

Artist's Impression



**ELEVATE TO  
TIMELESS CONVENIENCES**



**ELEVATE TO  
TIMELESS EXPERIENCES**



Artist's Impression

# GROUND FLOOR PLAN

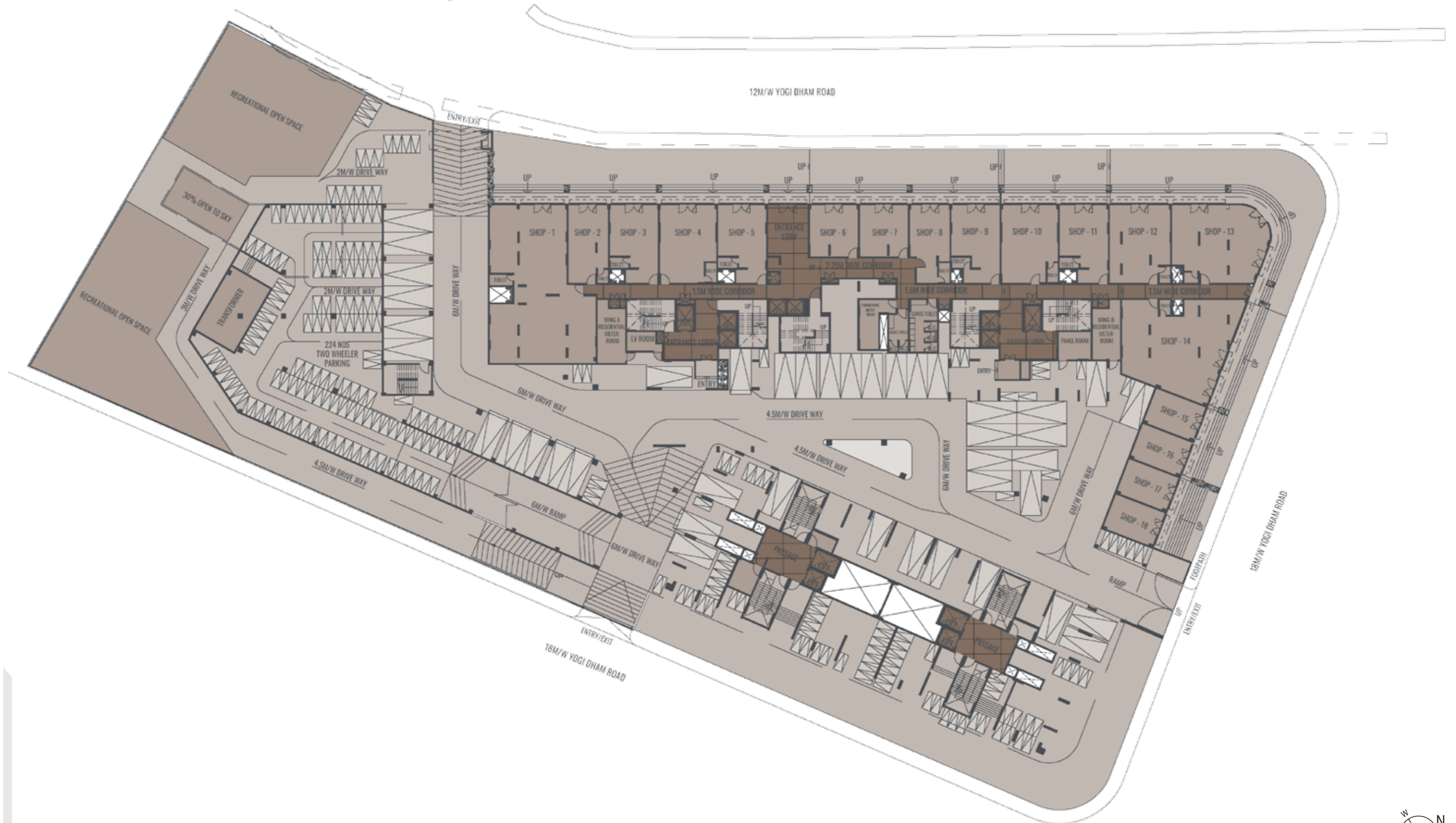

# FIRST FLOOR PLAN

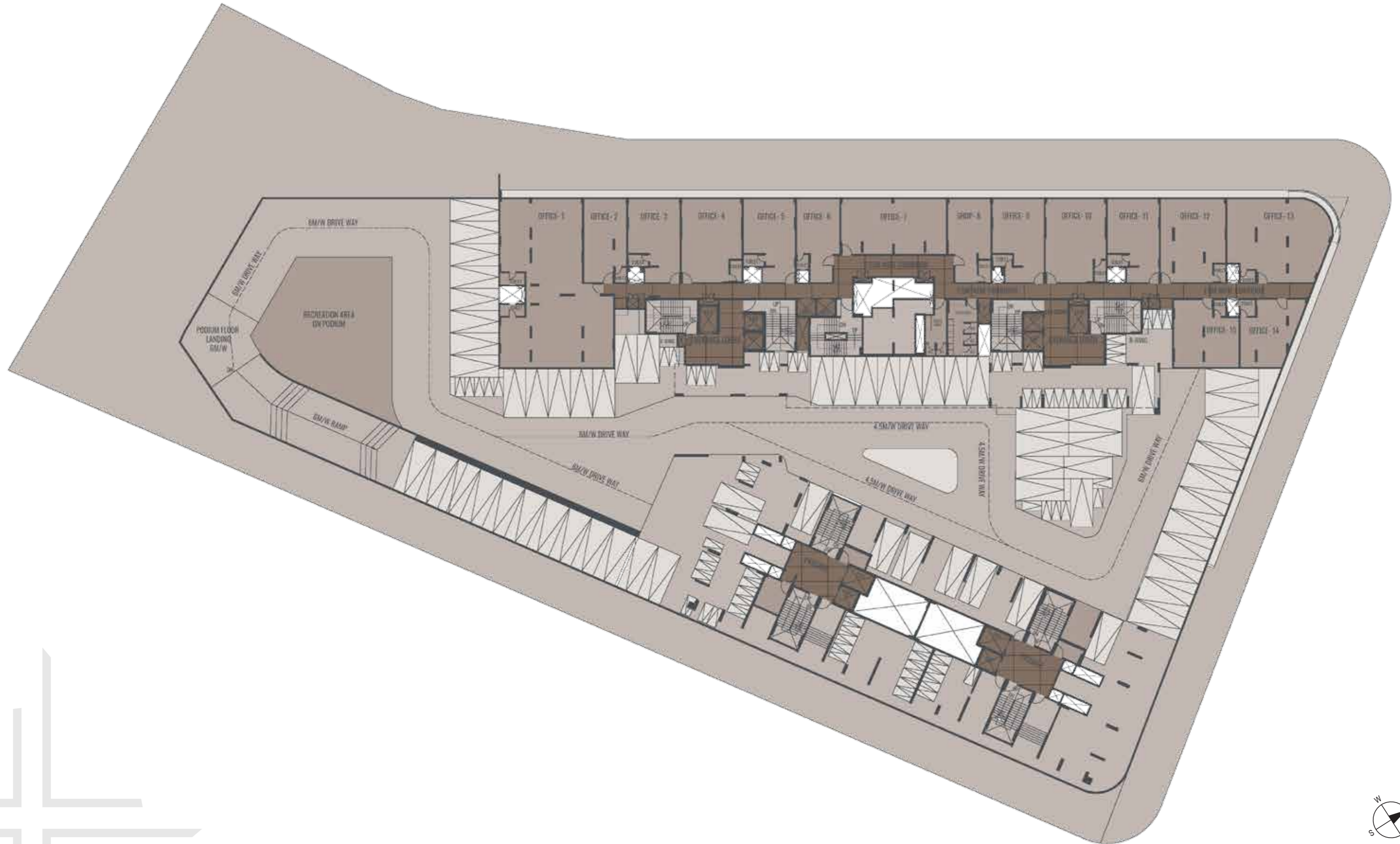

# FEW OF THE MANY REASONS FOR YOU TO BUY YOUR DREAM HOME!

---

## LOCATED IN THE HEART OF KALYAN - YOGI DHAM

Flourishing at a fast pace, Yogidham is one of the prominent housing societies in Kalyan. An Ideal destination to live in with all the conveniences of the world around you.

---

## IDEAL DESTINATION FOR INVESTMENT

With growing premium residential and commercial projects in the vicinity, it is a perfect place to invest in. An ever increasing property price appreciation makes this place the Idea destination for investment.

---

## ESTABLISHED NEIGHBOURHOOD

Railway stations, schools, hospitals, colleges, malls, recreational centres, bus stops, eateries and grocery marts nearby. There is no place far away from the place you would love to call your home.

---

## FAST - PACED GROWTH

With upcoming metros, highways & other infrastructural developments, Kalyan is becoming one of the most promising location to live and to invest in for every homebuyer.

---

## CONNECTIVITY TO IMPORTANT JUNCTIONS

Connects to Thane, Nashik, Navi Mumbai and Mumbai; even to Bhiwandi, Badlapur and Alibaug.

---

## SURROUNDED BY SCENIC BEAUTY

Being so close to the city, this location also has an advantage of being surrounded by alluring views of hills and a river.



A PROJECT BY



[www.mehtagroup.net.in](http://www.mehtagroup.net.in) | [www.happyhomeproperties.in](http://www.happyhomeproperties.in)

Site Address: Cornerstone, Gholap Nagar, Yogidham, Kalyan West - 421 301.



The project is registered under MahaRERA No P51700032175 and is available on website <https://maharera.mahaonline.gov.in> under registered projects.



9619888274

7208753250

Disclaimer: All the images, visuals, elevations, perspectives, illustrations, stock images, designs, drawings, maps, facilities, amenities, features, and other information here are in a conceptual, indicative and for representation purpose only and are not to scale, and is subject to the approval of the respective authorities. The Promoters / Developers reserve the right to add, alter, delete or replace any of these in the interest of the development, without any notice or obligation. All the matter presented here at the exhibition does not constitute any offer or contract of any nature whatsoever between the Promoters / Developers and the recipient. All transactions shall be subject to and governed by the terms & conditions of the Agreement for Sale to be entered into between the parties.